

COSTA GROVE

Delightful Living

Costa Grove is bounded by Pasir Ris Drive 3 and Pasir Ris Green. The development comprises 9 residential blocks ranging in height from 9 to 18 storeys with 1,070 units of 2-room Flexi, 3-, 4-, and 5-room flats. Two of these blocks also house some rental flats. An additional residential block dedicated to rental flats brings the total to 10 residential blocks in Costa Grove.

The name Costa Grove reflects the development's location in the coastal town of Pasir Ris, which is named after the long stretch of sandy white beach along the north-eastern coastline of Singapore and the adjacent Sungei Api Api, which is famous for its mangroves.

Costa Grove 位于巴西立第3道（Pasir Ris Drive 3）和巴西立绿道（Pasir Ris Green）之间。该住宅区有9栋住宅楼，楼高从9层至18层不等，共有1,070个单位，包括二房灵活单位、三房式、四房式和五房式组屋单位。其中两栋楼也没有部分出租单位。另有一栋专门提供出租单位的住宅楼，使 Costa Grove 的住宅楼总数达到10栋。

Costa Grove 这个名字反映了该住宅区位于滨海城镇巴西立的地理位置。巴西立得名于新加坡东北海岸那一长段洁白的沙滩，以及附近以红树林闻名的阿比阿比河（Sungei Api Api）。

Costa Grove terletak di antara Pasir Ris Drive 3 dan Pasir Ris Green. Pembangunan ini merangkumi 9 blok kediaman dengan ketinggian antara 9 hingga 18 tingkat, mengandungi 1,070 unit flat jenis Flexi 2 bilik, 3 bilik, 4 bilik, dan 5 bilik. Dua daripada blok ini turut menempatkan beberapa unit flat sewa. Sebuah lagi blok kediaman khas untuk flat sewa menjadikan jumlah keseluruhan blok kediaman di Costa Grove kepada 10 blok.

Nama Costa Grove mencerminkan lokasi pembangunan ini di bandar pesisir Pasir Ris, yang dinamakan sempena pantai berpasir putih yang panjang di pesisir timur laut Singapura serta Sungai Api Api yang terkenal dengan hutan paya bakau.

Costa Grove, பாசிர் ரிஸ் டிரைவ் 3 மற்றும் பாசிர் ரிஸ் கிரீன் இடையே அமைந்துள்ளது. இது 9 முதல் 18 மாடிகள் வரை உயரமுடைய 9 குடியிருப்பு புளோக்குகளைக் கொண்டுள்ளது. இவற்றில் 2-அறை ஃப்ளெக்சி (Flexi), 3-, 4-, மற்றும் 5-அறை வீடுகள் என 1,070 வீடுகள் உள்ளன. 2 புளோக்குகளில் சில வாடகை வீடுகளும் உள்ளன. மேலும், வாடகை வீடுகளுக்காக மட்டும் ஒதுக்கப்பட்ட ஒரு குடியிருப்பு புளோக் இருப்பதால், Costa Grove-ல் மொத்தம் 10 குடியிருப்பு புளோக்குகள் உள்ளன.

Costa Grove என்ற பெயர், கடலோர நகரமான பாசிர் ரிஸ்-ல் அதன் இருப்பிடத்தையும், அருகிலுள்ள சதுப்பு நிலங்களுக்குப் பெயர் பெற்ற சுங்காய் அபி அபி ஆற்றையும் பிரதிபலிக்கிறது. பாசிர் ரிஸ், சிங்கப்பூரின் வடகிழக்கு கடற்கரையை ஒட்டிய நீளமான வெண்மணல் கடற்கரை என்பதிலிருந்து தனது பெயரை பெற்றுள்ளது.

Site plan for Costa Grove

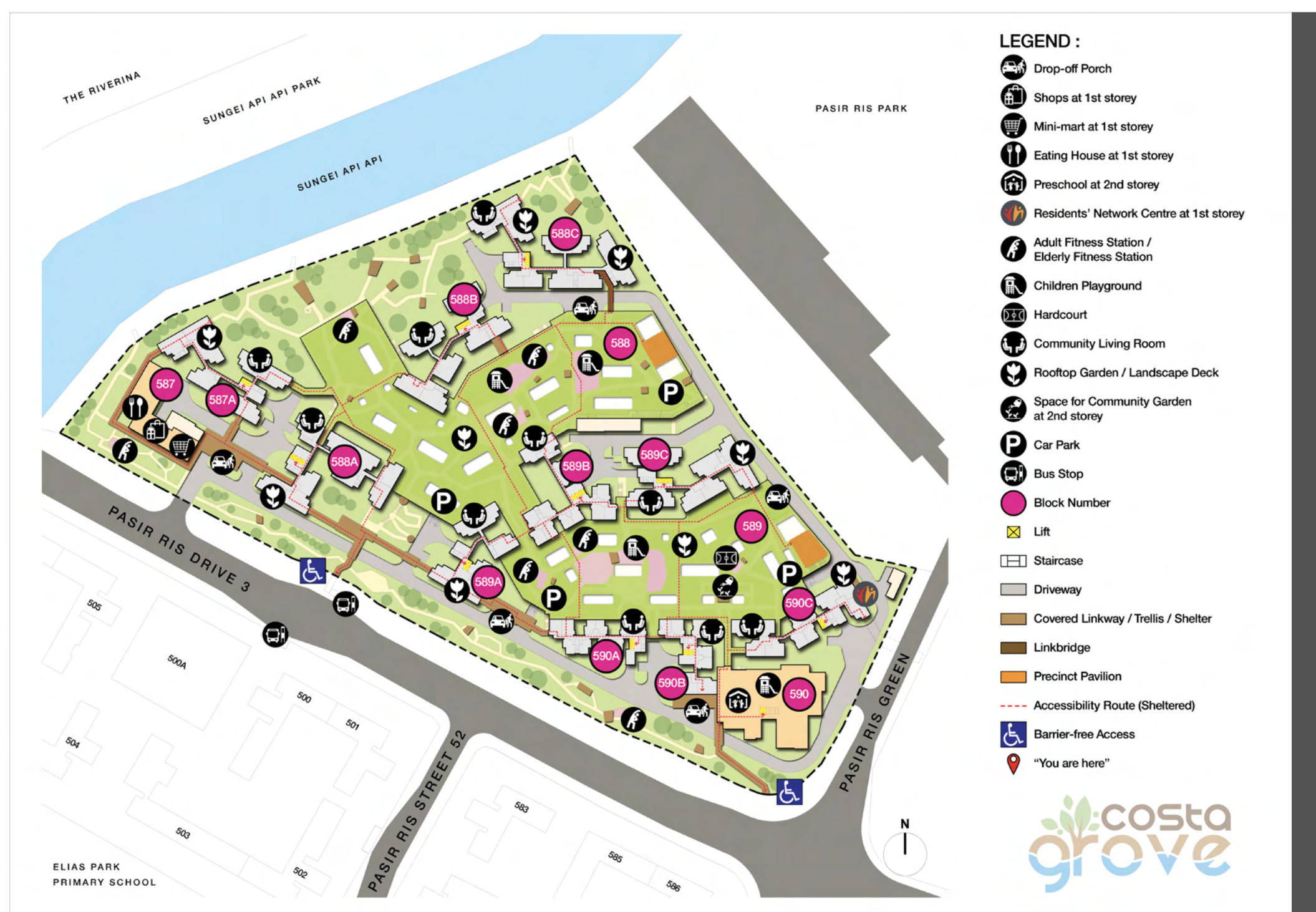

Amenities Within Reach



Costa Grove comes with roof gardens in some blocks, providing a platform for residents to connect with family and neighbours. Residents can look forward to outdoor recreational facilities such as playground and fitness centres. Residents can also enjoy leisurely strolls, cycling, or rollerblading along the adjacent linear green, Sungei Api Api, or explore the nearby Pasir Ris Park.

Within Costa Grove, there is commercial precinct cluster consisting of an eating house, a minimart and shops, which residents can patronise for daily needs. There is also a preschool, and a Residents’ Network Centre.

Costa Grove is located a few minutes’ walk to Pasir Ris MRT Station. Travelling to and from Costa Grove is also made easy as the Tampines Expressway (TPE) is a short drive from the development. Please refer to Land Transport Authority’s **Your Costa Grove Travel Guide** to find out more about the transport connections for your development.

Costa Grove is served by Pasir Ris Central Community Club. Follow them via Facebook (**Pasir Ris Central CC**) to find out more on the activities available!

Lovely Homes

Costa Grove comprises 2-room Flexi, 3-, 4-, and 5-room flats.

The 2-room Flexi flats come in two sizes (36 sqm and 45 sqm) and are available either on a 99-year lease or short-lease. These flats come with:

- floor tiles in the kitchen, household shelter, and bathroom
- wall tiles in the kitchen and bathroom
- a sliding partition/ door for the bedroom and folding bathroom door
- water closet suite in the bathroom

2-room Flexi flats where homeowners have opted for the Optional Component Scheme, have flooring in the living, dining and bedrooms, as well as sanitary fittings such as wash basin with tap mixer and shower set.

The 2-room Flexi flats on short-leases, which are for the elderly, are fitted with grab bars. In addition, 2-room Flexi flats on short-leases where homeowners have opted in for Optional Component Scheme also have the build-in kitchen cabinets and built-in bedroom wardrobe included in their flats.

The 3-room, 4-room and 5-room flats have floor finishes in the kitchen, service yard, household shelter and bathrooms. Wall tiles are provided in the kitchen and bathrooms.

The 3-room flats feature an open-concept kitchen, offering a flexible layout with a dry kitchen and combined kitchen/utility space. Homeowners can customize this area to suit their needs by adding partitions, for example, to separate:

- Utility from Kitchen
- Dry and Wet Kitchens
- Kitchen from Living/ Dining area



Eco-Friendly Living

Costa Grove is designed with several eco-friendly features to encourage green and sustainable lifestyle among residents. These features include separate chutes for recyclable waste; regenerative lifts to reduce energy consumption; bicycle stands to encourage cycling as an environmentally friendly form of transport; parking spaces to facilitate future provision of EV charging; use of sustainable and recycled products in the development such as PVC edges and EPDM rubber mats; Active, Beautiful, Clean Waters design features to clean rainwater and beautify the landscapes.

Costa Grove also features Smart Lighting in common areas to reduce energy usage, contributing to a more liveable, sustainable, and safer living environment.



Separate chutes for recyclable waste



Bicycle stands to encourage cycling



ABC Waters design features

© 2025 Housing & Development Board.
All rights reserved.

